

Using Data from BIMs as Input for a 3D Cadastre

Supervisors: Wilco Quak, Peter van Oosterom (TU Delft), Jeroen van der Veen (Dutch *Kadaster*)
and Jakob Beetz (TU Eindhoven).

Contents

- Background: BIM Open Standards
 - Use Case: Lakeside Restaurant
 - Workflow

BIM Open Standards

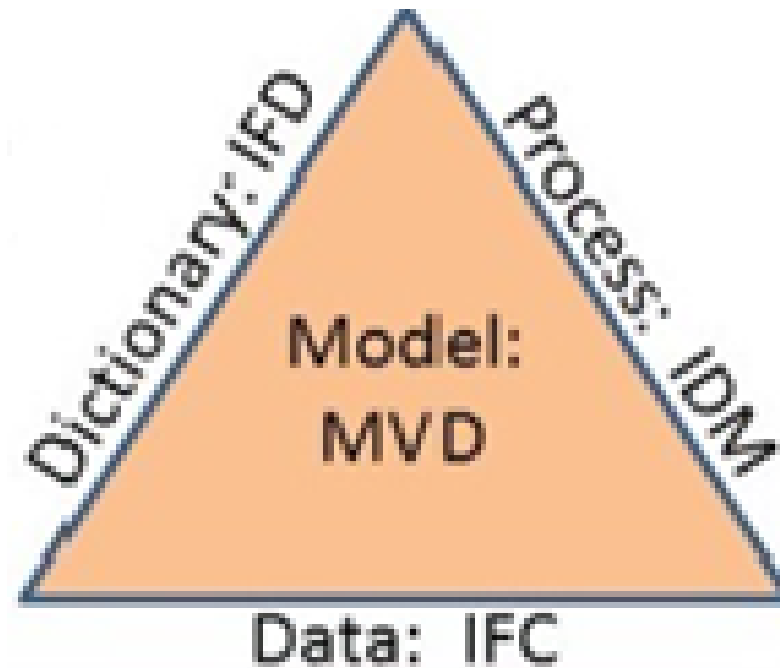

Can Data from BIMs be Used as Input for a 3D Cadastre?
Background

Lakeside Restaurant: in a 2D Cadastre

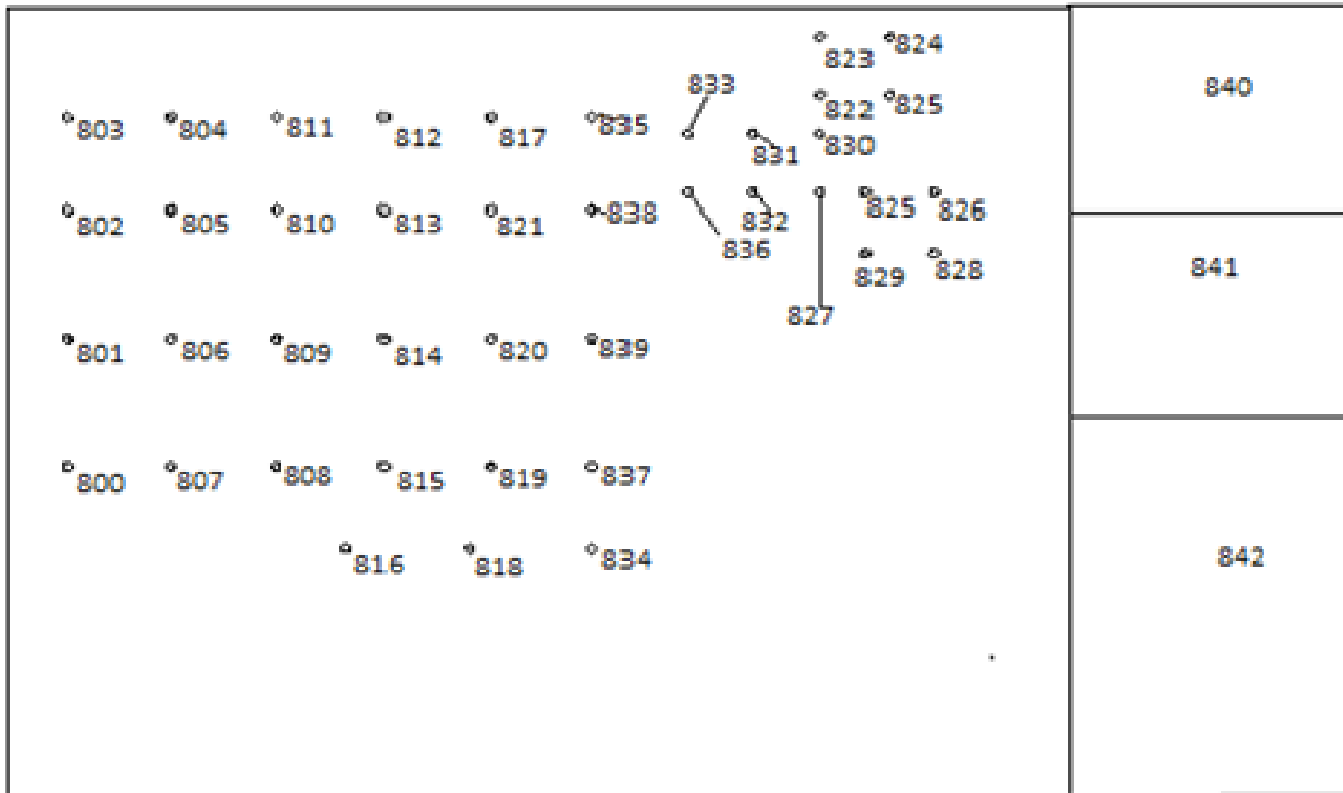

Data set courtesy
of the National
Building
Specification UK

Can Data from BIMs be Used as Input for a 3D Cadastre? Use
Case

The *Industry Foundation Class's* (IFC) Space Objects and Zones

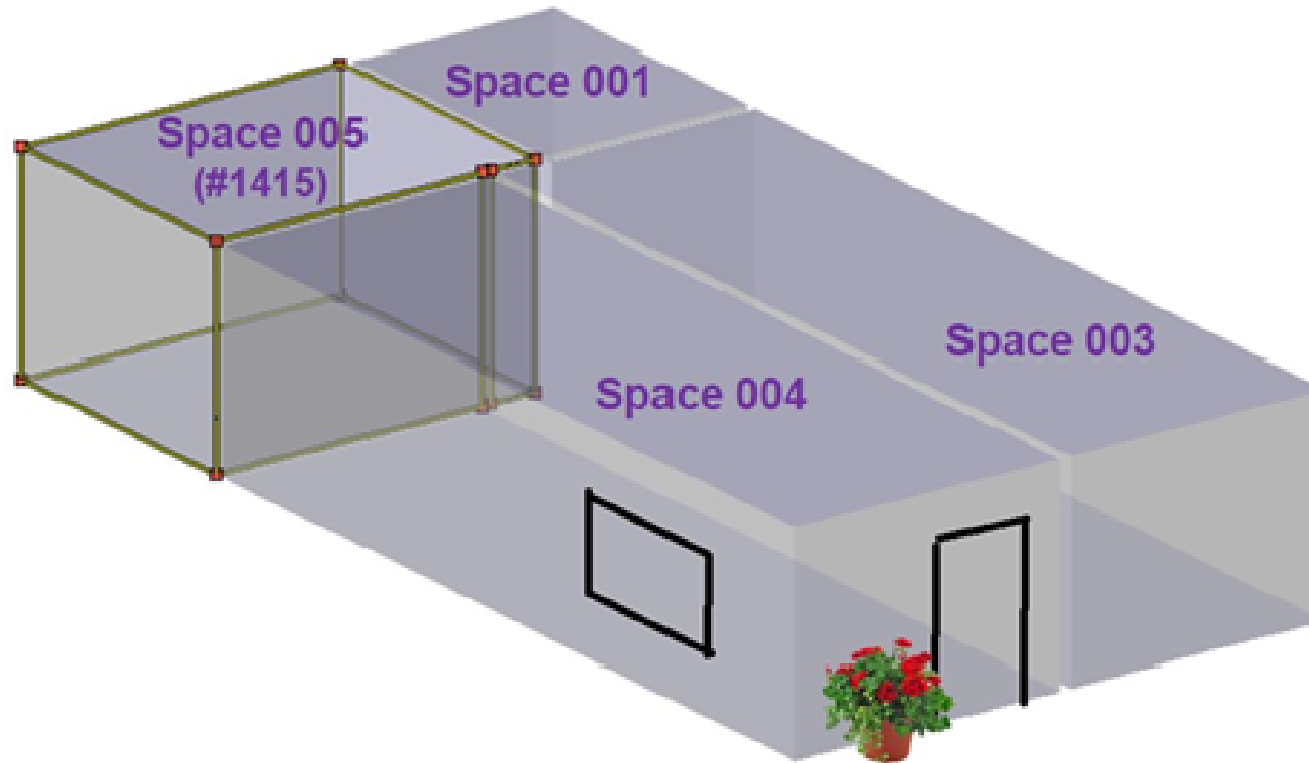

Can Data from BIMs be Used as Input for a 3D Cadastre? Use Case

Lakeside Restaurant: IFC Space Object

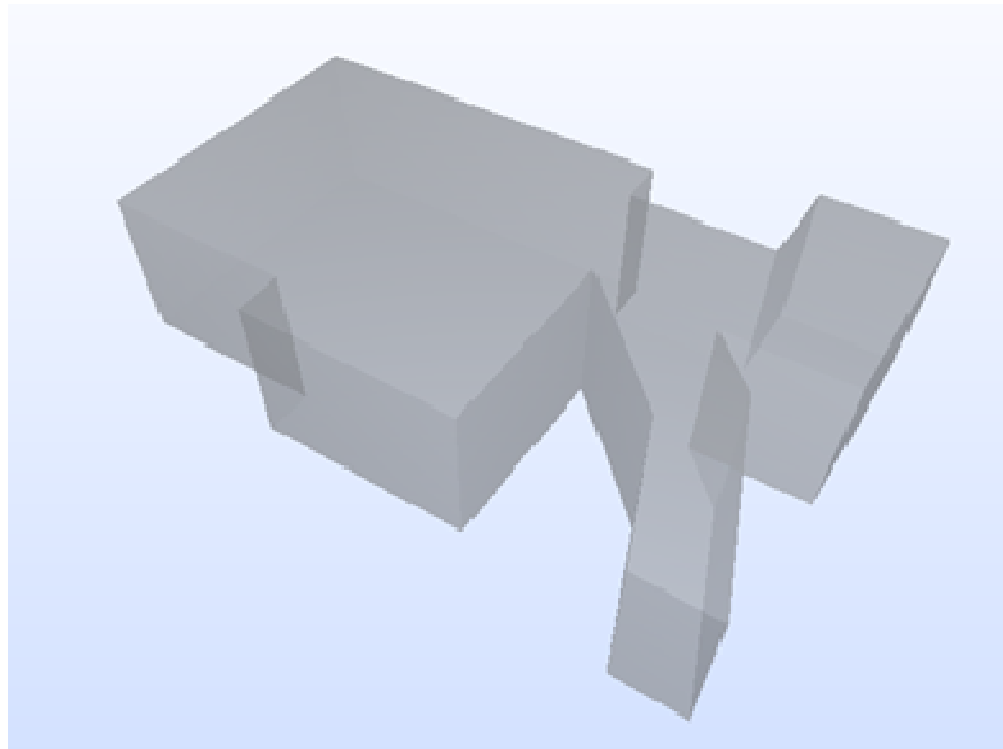

Can Data from BIMs be Used as Input for a 3D Cadastre? Use
Case

Lakeside Restaurant: Zones

<HVAC Zone
A
Gross Volume
0.000 m ³

HVAC - Heating Ventilation
Air Conditioning

Lakeside Restaurant: Photograph



Can Data from BIMs be Used as Input for a 3D Cadastre? Use
Case

Workflow: getting in on the act

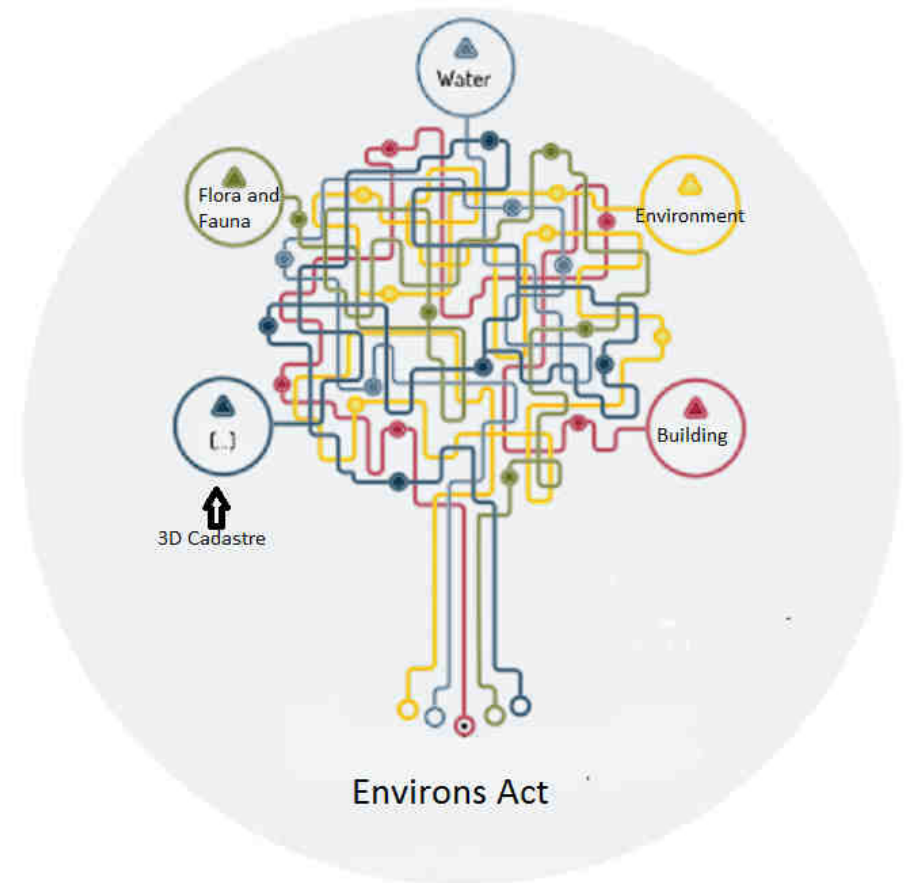
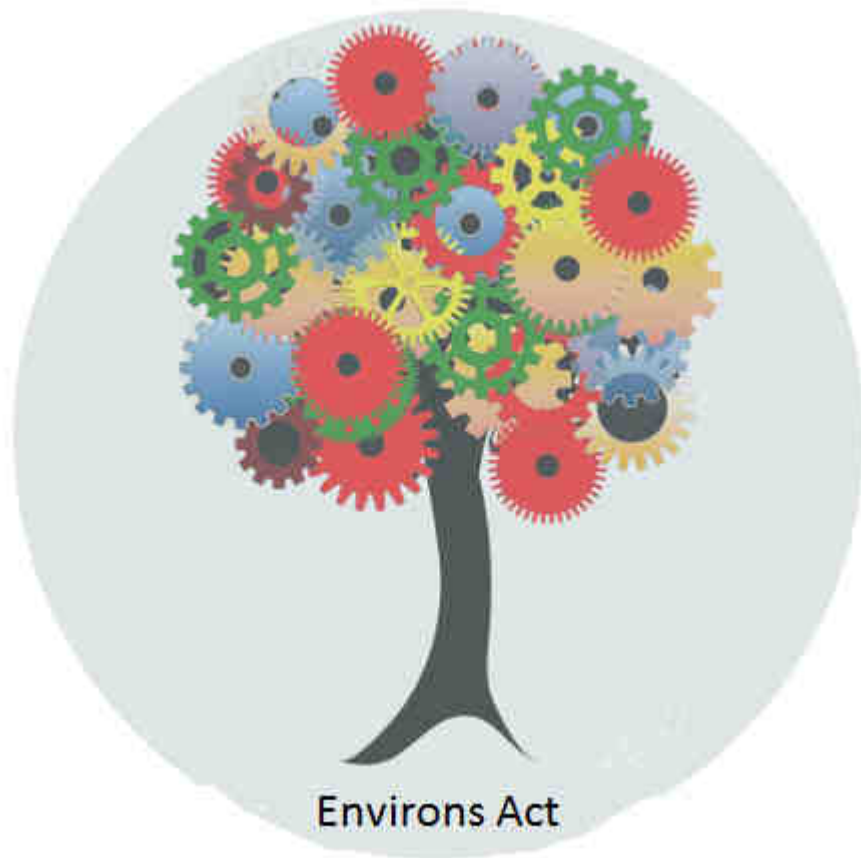

Can Data from BIMs be Used as Input for a 3D Cadastre?
Workflow

Workflow: Using the Information Delivery Manual (IDM) to communicate - 1

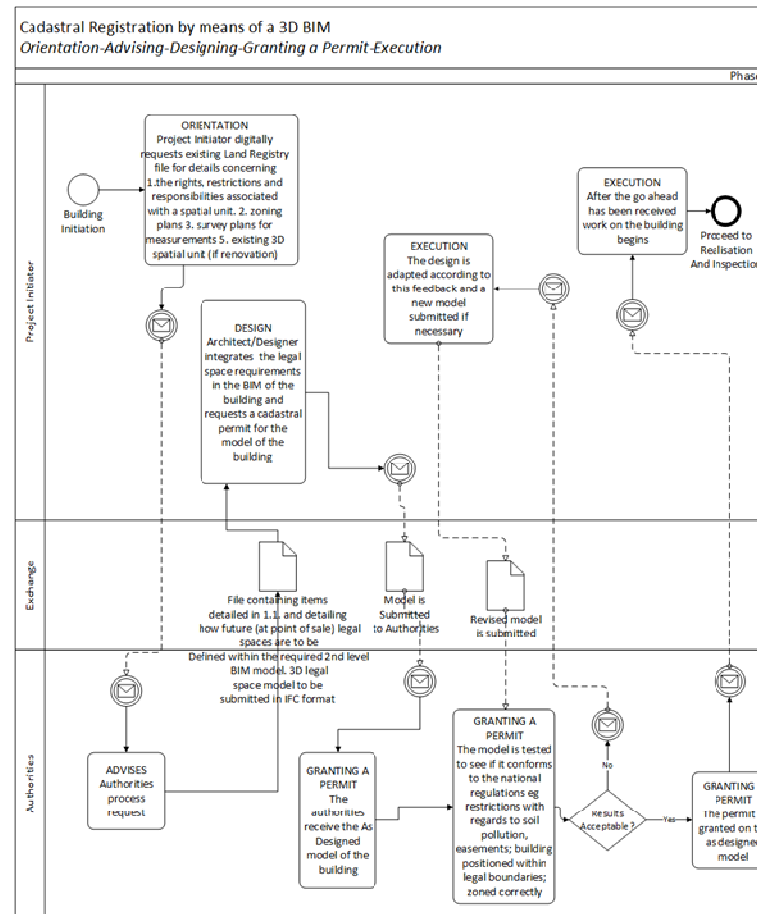

Can Data from BIMs be Used as Input for a 3D Cadastre?
Workflow

Workflow 2:

Using the Information Delivery Manual (IDM) to communicate - 2

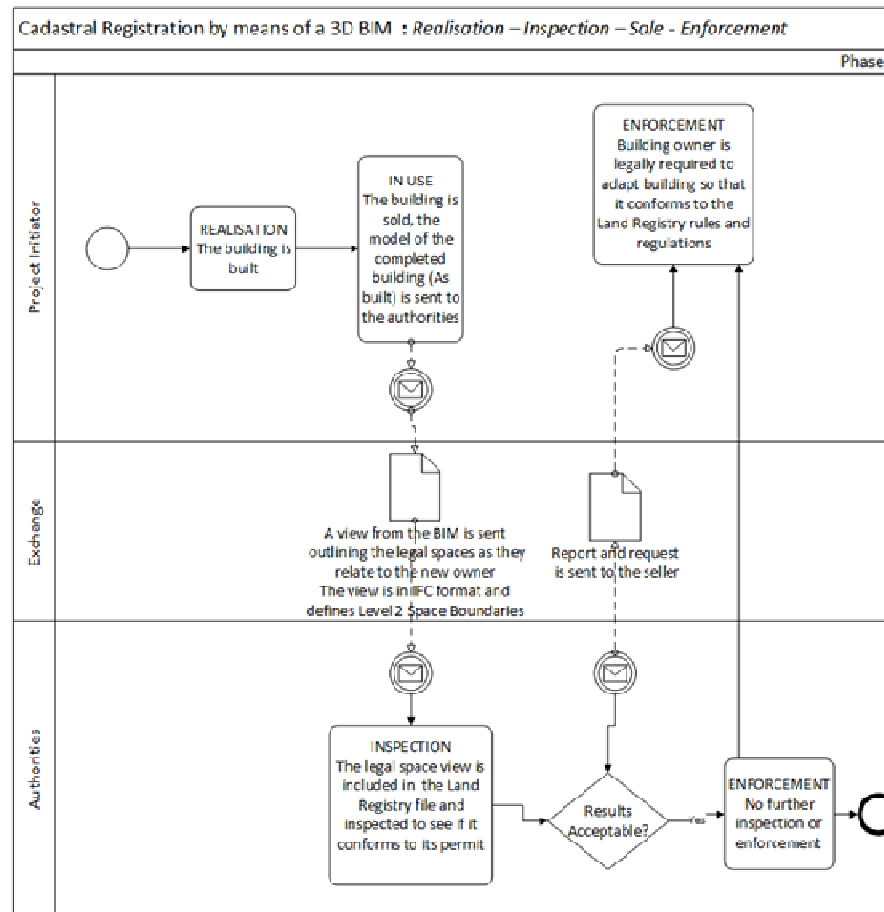

Can Data from BIMs be Used as Input for a 3D Cadastre?
Workflow

Thank you to my sponsors...

 **TU Delft**

Universiteitsfonds



Questions?